



the ERIE Tool Works company

ENGLISH  
E-1824-BXR

**IMPORTANT** For Parts & Service **DO NOT RETURN** the product to the store  
Contact our customer service team for assembly questions, parts or service

TEL: 866-316-3743

service@ETWcompany.com

ASSEMBLY VIDEO -- [www.ERIEtoolworkscompany.com](http://www.ERIEtoolworkscompany.com)

**PROPER OPERATION**

For best results, use on moist ground  
Do not store water filled unit in freezing temperatures

**TOOLS & TIPS**

Confirm you have all the parts and hardware  
Tools not included 1) flat screwdriver 2) adjustable wrench

**PARTS LIST**

Qty	Description		
1	Handle Bar		
2	Handle Bar Support		
2	Handle Bar Bracket		
2	"Y" Handle		
1	Scraper Bar		
1	Roller Drum		
1	Fill Cap		
1	Hardware Bag		
Hardware bag contents			
5/16" Bolts:	1 - 1-3/4"	1 - Large 1/2" Bolt	2 - Large Washers
4 - 1"	2 - 2-1/4"	2 - Cotter Pins	2 - Nylon Bushings
1 - 1-1/4"	2 - 1/2"	2 - Nylon Spacers	

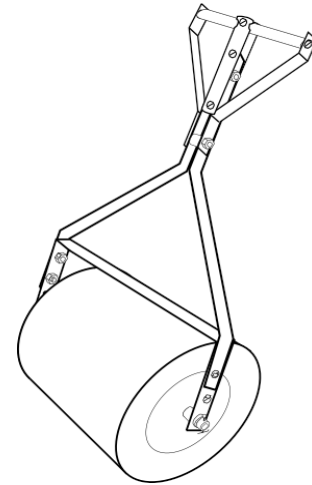

**INSTRUCTIONS - Handle Assembly**

- 1) Attach one "Y" Handle to one side of the Scraper Bar using 2 - 1" Bolts. Repeat for the other side. Tighten bolts.
- 2) Fasten the tops of the "Y" Handles together using 1 - 1-1/4" Bolt and a Nylon Spacer in the top hole.
- 3) Attach the two Handle Bar Supports to the top of the "Y" Handles using 1 - 1-3/4" Bolt and a Nylon Spacer in the bottom hole.
- 4) Attach the Handle Bar to the Handle Bar Supports using 2 - 1/2" Bolts.
- 5) Attach the two Handle Bar Brackets to the top of the "Y" Handle using 2 - 2-1/4" Bolts and to the Handle Bar using 1 Large 1/2" Bolt.

Steps 2 & 3

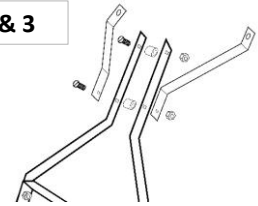

Steps 4 & 5

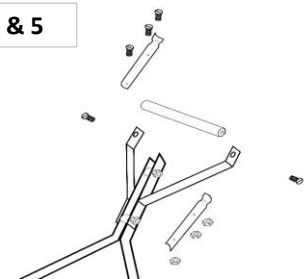

**INSTRUCTIONS - Attach the Roller Drum to the Handle Assembly**

- 6) Slide a Nylon Bushing on each end of the Axle and spread the Scraper Bar over each end of the Axle on to the Bushings.
- 7) Add a Washer and Cotter Pin to the end of each Axle.
- 8) Tighten all Bolts.