



the ERIE Tool Works company

ENGLISH
E-1035 / E-1038 / E-1039

IMPORTANT For Parts & Service **DO NOT RETURN** the product to the store

Contact our customer service team for assembly questions, parts or service

TEL: 866-316-3743

service@ETWcompany.com

ERIEtoolworkscompany.com

SAFETY

NEVER over inflate an Air Tire

NEVER use an air compressor to inflate an Air Tire

NEVER allow a person to climb on, or ride in, a wheelbarrow

TOOLS & TIPS

Confirm you have all the parts and hardware

Do not fully tighten bolts until final assembly is complete

Tools not included 1) Hammer 2) adjustable wrench

PARTS LIST

Qty	Description
1	Tray
2	Handles
2	Legs
1	Curved Leg Brace
2	Diagonal Leg Brace
2	Tray Braces
1	Short Cross Brace
1	Long Cross Brace
2	Wedges
1	Axle & Bearing
1	Nose Guard
1	Wheel
1	Hardware Bag

ASSEMBLY

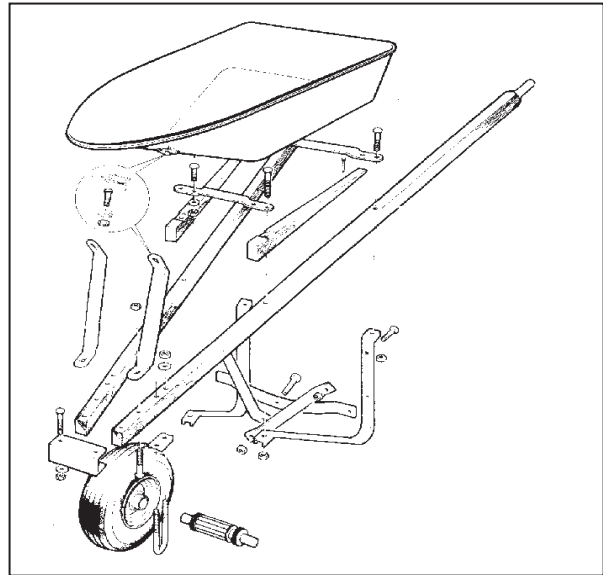

HARDWARE CHART

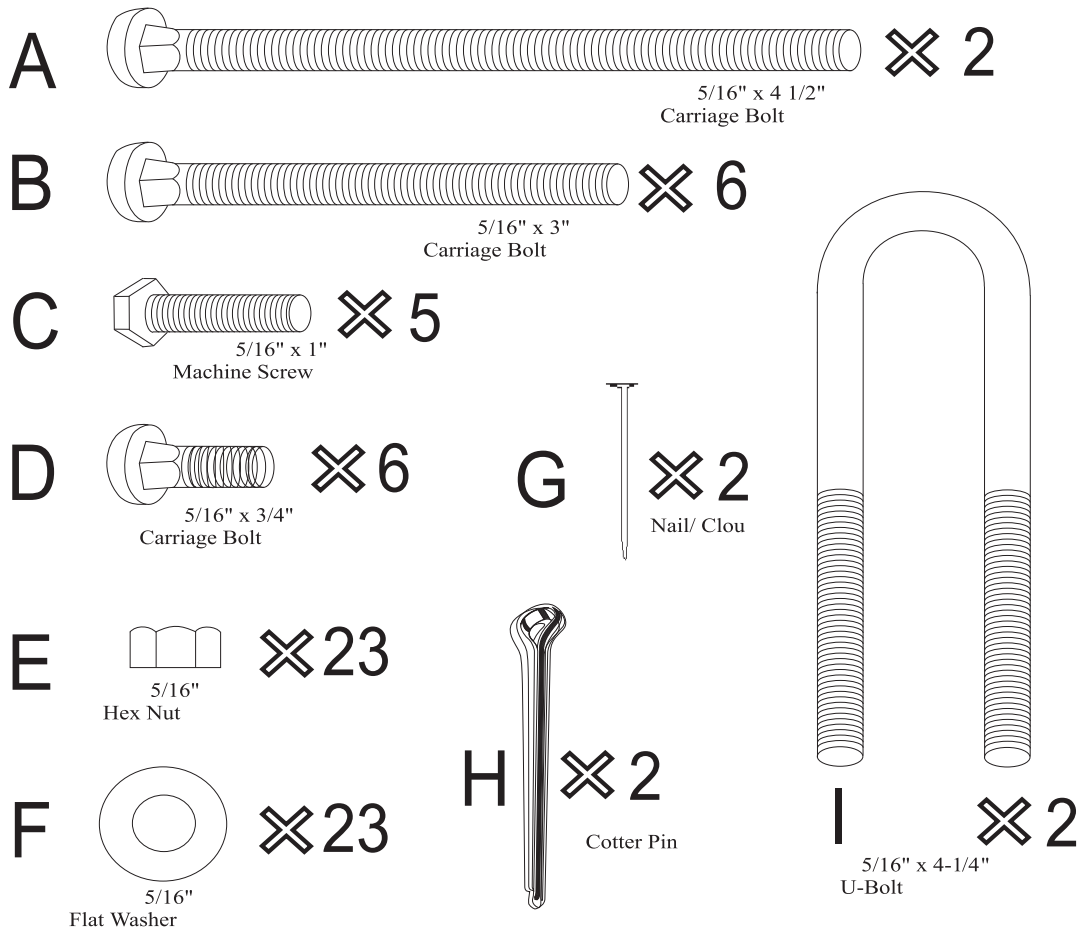



the ERIE Tool Works company

ENGLISH E-1035 / E-1038 / E-1039

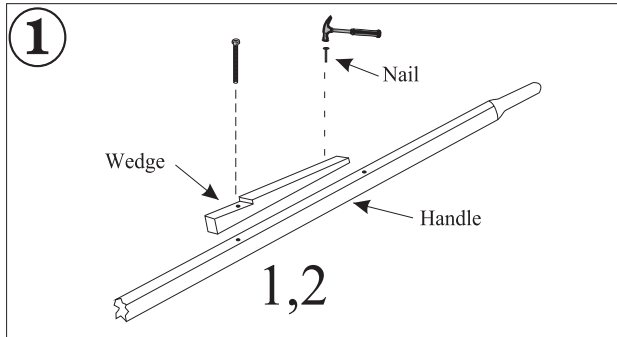

1 Place the hole in the wedge over the second hole in the handle (from handle grip). **TIP:** Temporarily insert 4 1/2" carriage bolt (A) through wedge then handle to keep wedge in proper location. "Contractor" name should be facing up when attaching the wedge.

2 Use nail (G) provided to secure wedge in place. Thin end of wedge points towards handle grip. Hammer the nail approx. 2" from the thin end of wedge.

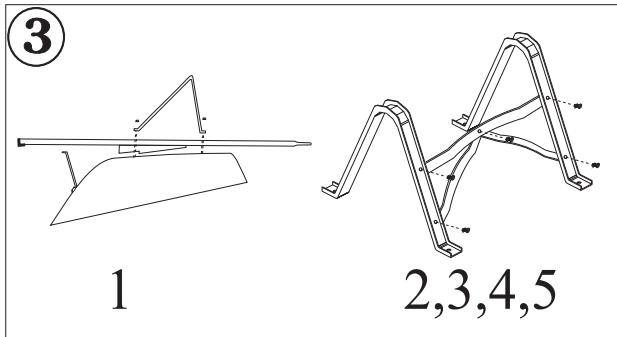

1 Place each handle with the wedge toward tray over 4-1/2" and 3" carriage bolts.

2 Place C-channelled legs on the bolts (A) and (B) ensuring that the holes for the curved cross piece are to the rear of the tray.

3 Add nuts (E) to the four [4] bolts. **Tighten nuts by hand only.**

4 Using two [2] 1" machine screws (C), place the curved cross piece on the holes closest to the top so the bend is to the front of the tray.

5 Place the two lower diagonal braces as shown above and hand tighten with three [3] 1" machine screws (C) and three [3] hex nuts (E).

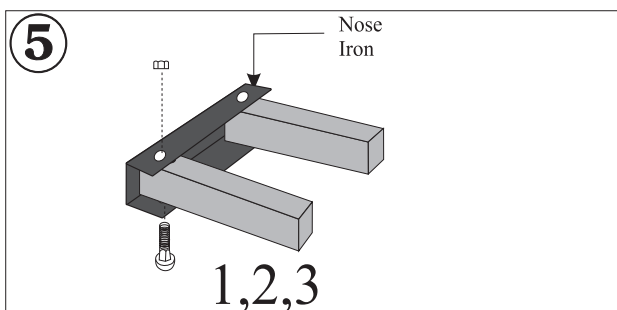

1 Place the nose iron on front ends of handles with nose iron slots toward the tray.

2 Slide two [2] 3" carriage bolts (B) through nose iron and handle.

3 Add two [2] hex nuts (E). **Tighten nuts by hand only.**

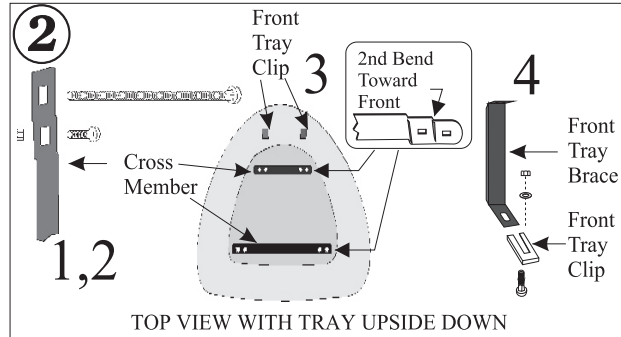

TOP VIEW WITH TRAY UPSIDE DOWN

1 Install 3/4" carriage bolts (D) and nuts (E) through inner two slots of both cross members. **DO NOT TIGHTEN NUTS COMPLETELY.**

2 Insert 4-1/2" carriage bolts (A) through outer slots of short cross member and 3" carriage bolts (B) through long cross member.

3 Slide cross members onto tray clips, bolt heads in tray clips. Long cross member fits at rear of tray. **Tighten nuts on 3/4" carriage bolts by hand only. You should not have nuts on 4-1/2" and 3" bolts.**

4 Place two [2] 3/4" carriage bolts (D) into front tray clips, then add front tray braces, two [2] washers (F) and two [2] 5/16" hex nuts (E). Hand tighten only.

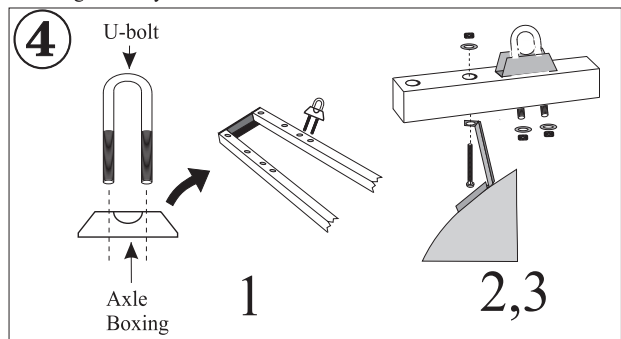

1 Slide each U-bolt (I) through each axle boxing with raised edges of axle boxing toward U-bolt. Slide each U-bolt through handle with half moon cut-out of axle boxing towards inner sides of each handle.

2 Place front tray braces through two [2] 3" carriage bolts (B) then the handles and add two [2] washers (F) and two [2] hex nuts (E).

3 Add four [4] washers (F) to U-bolts and four [4] nuts (E). **Do not tighten nuts!**

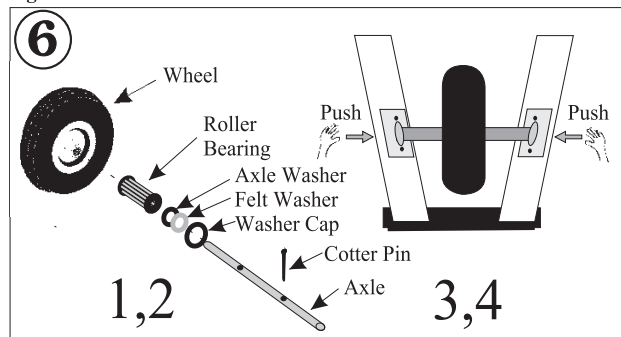

1 This axle unit has been assembled for you. To install remove one cotter pin and one washer cap. We recommend you grease the roller bearing before use. Slide the axle assembly through the wheel hub. Replace the washer cap and cotter pin.

2 Use hammer to bend split end of cotter pins so they don't fall out.

3 Place wheel assembly between axle boxings and U-bolts. You will need one hand to keep handles 'snug' to axle until nuts are tightened.

4 **Tighten U-bolt nuts securely now.**

5 **YOU CAN TIGHTEN ALL OTHER NUTS SECURELY NOW, DO NOT OVER-TIGHTEN!**